

This cabinet is designed to meet all British Columbia Ministry of Transportation requirements and is used for road and streetside controls, primarily traffic pre-emption.

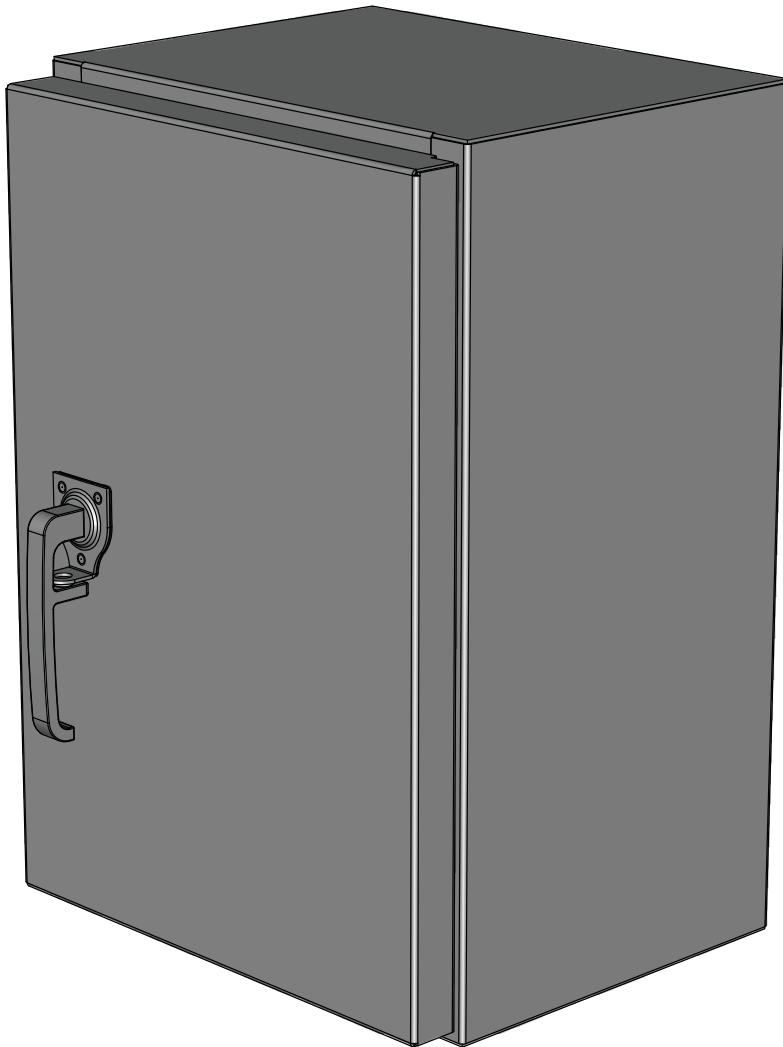

### Features

- 304 (#4) stainless or marine-grade aluminum construction
- Aluminum enclosures are powder-coated ASA 61 Grey
- NEMA 3R rated
- Padlockable stainless steel handle
- Pole mounting holes on back
- Hidden hinges for added security
- 2" chase nipples
- Full aluminum backpan
- Pole wiring access hole and chase nipple
- All mounting hardware included

### Specifications

- ETL certified to applicable CSA and UL standards
- MOTBC approved

### Optional Components

- Heater and thermostat
- Fan and thermostat
- Shelves
- Pre-punched backpan
- Power distribution equipment
- Humidistat

### Benefits

This cabinet can be used for a large variety of applications and with the aluminum or stainless steel metal composites it will handle the harsh conditions of roadside applications. With the optional heater and fan combinations the control devices will work without problems associated with many other enclosures.

It is supplied with a 2" chase nipple used to access the pole and stainless steel mounting hardware.



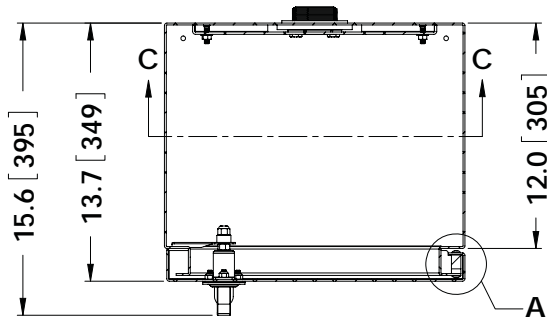

SECTION B-B

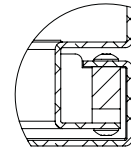

DETAIL A

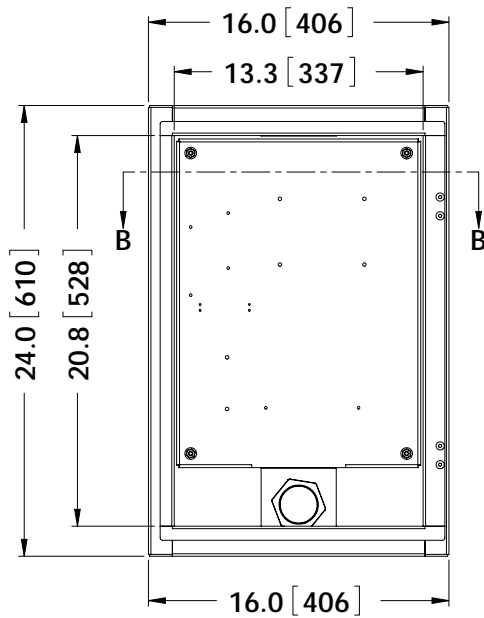

FRONT VIEW  
(DOOR REMOVED)

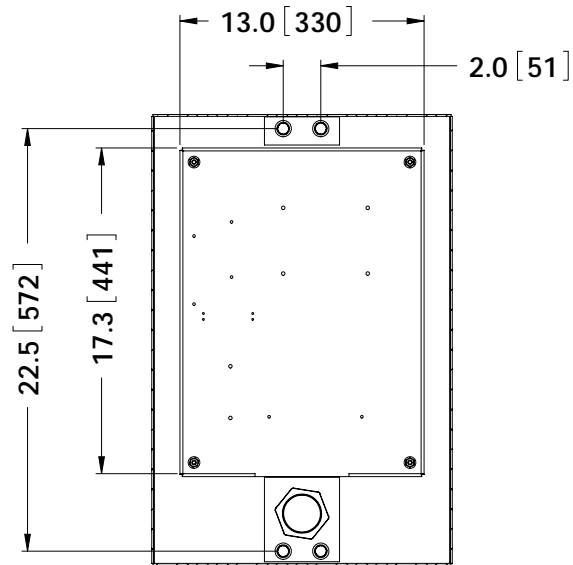

SECTION C-C  
(BACK PANEL)

ELECTRICAL/  
CONTROL CABINETS

PART NUMBER	HEIGHT	WIDTH	DEPTH	MATERIAL
SPW01-A	24"	16"	12"	ALUMINUM
SPW01-S	24"	16"	12"	STAINLESS STEEL

FOR ADDITIONAL OPTIONS CONSULT FACTORY