

This pedestal style is a direct burial design providing the RV owner with a single power point. All receptacles are protected by breakers on the pedestal and the check meter allows monitoring of power consumption.

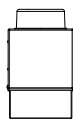

TOP VIEW

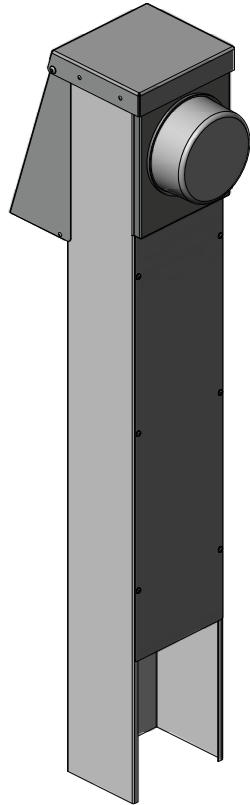

7.0 [178]
FRONT VIEW

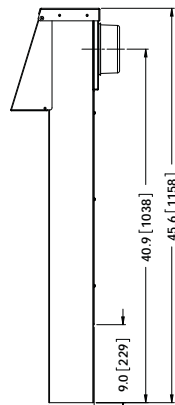

5.3 [133] 9.0 [229] 40.9 [1038] 45.6 [1158]
SIDE VIEW

Features

- Galvanized steel construction
- Aluminum cap for additional corrosion protection
- NEMA 3R rated
- Loop feed power termination lugs
- Series electrical design (larger amperage breaker protects lower amperage breakers) to prevent main service overload
- Padlockable cover
- 100A meter socket
- Stainless steel exterior hardware
- Low voltage section available
- Standard Parks Green powder coat finish

Specifications

- ETL certified to applicable CSA and UL standards
- 10,000 AIR
- 34"H x 7"W x 5.25"D galvanized steel construction
- 24" direct burial spade distance
- Aluminum cap
- Standard splitter blocks #14-2/0

Optional Components

- Top light
- Side light
- Photocell
- Central metering systems
- Low voltage section with cable telephone or network outlets
- Custom lug configurations
- Custom RAL powder coat colours including beige, grey and white



STANDARD RVBM PRODUCTS

PART NUMBER	RECEPTACLES		BREAKERS	
	QTY	TYPE	QTY	TYPE
RVBM1	1	15A GFI DUPLEX	1	15A 1P
RVBM2	2	15A GFI DUPLEX	2	15A 1P
RVBM3	1	15A GFI DUPLEX	1	15A 1P
	1	30A 125V CROWFOOT	1	30A 1P
RVBM4	1	15A GFI DUPLEX	1	15A 1P
	1	30A 125V CROWFOOT	1	30A 1P
	1	50A 125/250V	1	50A 2P
RVBM5	1	15A GFI DUPLEX	1	15A 1P
	1	50A 125/250V	1	50A 2P
RVBM6	1	20A GFI DUPLEX	1	20A 1P
RVBM7	2	20A GFI DUPLEX	2	20A 1P
RVBM8	1	20A GFI DUPLEX	1	20A 1P
	1	30A 125V CROWFOOT	1	30A 1P
RVBM9	1	20A GFI DUPLEX	1	20A 1P
	1	30A 125V CROWFOOT	1	30A 1P
	1	50A 125/250V	1	50A 2P
RVBM10	1	20A GFI DUPLEX	1	20A 1P
	1	50A 125/250V	1	50A 2P

OPTIONAL COMPONENTS
ADD TO PART NUMBER e.g. RVBM3-SPVL

OPTIONS	ADDER
TOP LIGHT	T
SIDE LIGHT	S
PHOTOCELL	P
CUSTOM LUGS	L
CABLE	C
TELEPHONE	V
NETWORK	N

ALTERNATE RECEPTACLE CONFIGURATION (MAXIMUM 3)
ADD TO PART NUMBER e.g. RVBM-AAM-SPV

RECEPTACLE	BREAKER	ADDER
15A DUPLEX GFI	15A 1P	A
20A DUPLEX GFI	20A 1P	B
15A DUPLEX	15A 1P	D
20A DUPLEX	20A 1P	E
15A TL 125V	15A 1P	F
20A TL 125V	20A 1P	G
30A CROWFOOT 125V	30A 1P	H
30A TL 125V	30A 1P	J
30A 125/250V	30A 2P	K
50A 125/250V	50A 2P	M
50A 125/250V TL	50A 2P	Q