

This is the back-to-back design in our premium power pedestal line. Robust aluminum construction and stainless steel hardware provides superior corrosion protection. Extra space enables easier termination and the standard LED light on the faceplate provides light where it is needed. The back-to-back configuration provides power to adjacent sites. The cover acts as a shield, providing a downlight when closed.

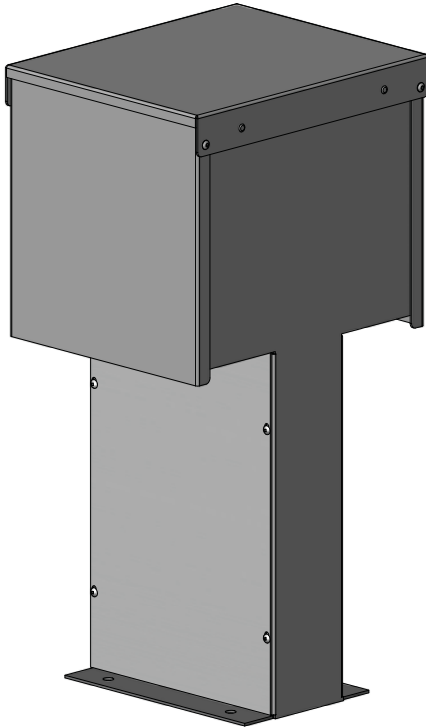

Features

- Marine-grade aluminum construction
- NEMA 3R rated
- Full size plug in breakers
- Built in LED illumination
- Stainless steel exterior hardware
- Low voltage section
- Back-to-back configuration
- Standard RAL powder coat colours

Specifications

- ETL certified to applicable CSA and UL standards
- 10,000 AIR
- 30"H x 11 3/4"W x 15 1/8"D aluminum construction
- Base plate 11 3/4" x 8 1/8"

Optional Components

- Top light
- Side light
- Photocell
- Feed through lugs
- Water manifolds

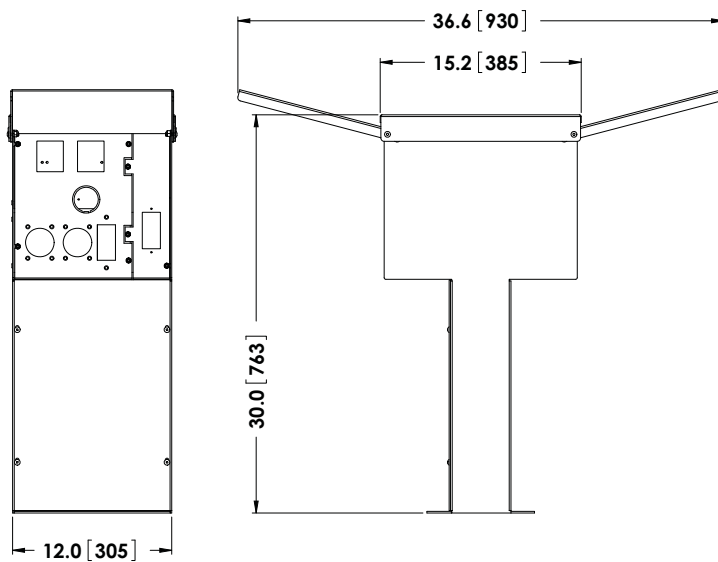

TYPICAL PRVD CONFIGURATION



STANDARD PRVD PRODUCTS (MAXIMUM 8 SINGLE POLE CCTS)
PART NUMBER PRVD-XXXXXX (WHERE X ARE THE RECEPTACLE ADDER)
 e.g. PRVD-AAMMHH

RECEPTACLE	BREAKER	ADDER
15A DUPLEX GFI	15A 1P	A
20A DUPLEX GFI	20A 1P	B
15A DUPLEX	15A 1P	D
20A DUPLEX	20A 1P	E
15A TL 125V	15A 1P	F
20A TL 125V	20A 1P	G
30A CROWFOOT 125V	30A 1P	H
30A TL 125V	30A 1P	J
30A 125/250V	30A 2P	K
50A 125/250V	50A 2P	M
50A 125/250V TL	50A 2P	Q

OPTIONAL COMPONENTS
 ADD TO PART NUMBER e.g. PRVD-AAMMHH-SPVL

OPTIONS	ADDER
TOP LIGHT	T
SIDE LIGHT	S
PHOTOCELL	P
CUSTOM LUGS	L
CABLE	C
TELEPHONE	V
NETWORK	N
WATER	W