

Valid Manufacturing produces a full range of custom NEMA 4 enclosures in multiple sizes, configurations, closures and hinge assemblies. Our custom capabilities allow us to design and build the enclosure to your specifications.

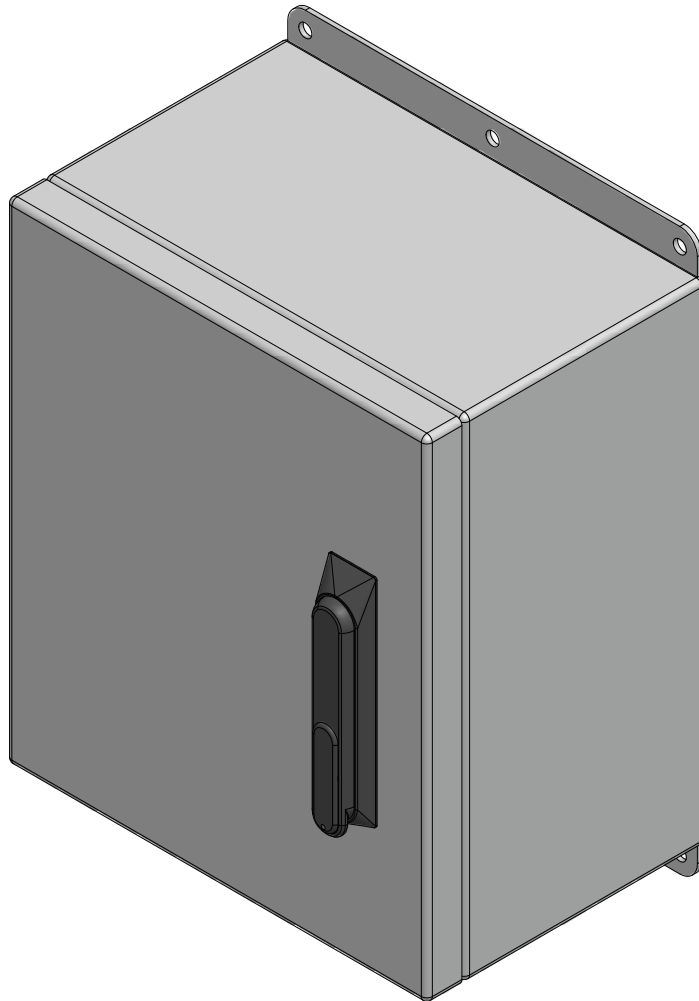

Features

- 304 (#4) stainless, marine-grade aluminum, or carbon steel construction
- Aluminum and steel enclosures are powder-coated ASA 61 Grey
- NEMA 4 rated
- Multiple handle configurations
- Full backpan
- Wall mount or free standing

Specifications

- ETL certified to applicable CSA and UL standards

Optional Components

- Heater and thermostat
- Styrofoam insulation
- Louvers and fans
- Shelves
- Side panels
- Electrical controls/power distribution
- Pre punched backpan
- Custom powder coat colours

Benefits

This is one example of the style of enclosure available in our NEMA 4 family. Multiple sizes and configurations can be produced to suit your specific application. This cabinet is usually powder coated ASA 61 Grey but additional colours are available.

