

This cast-in-place box is used in applications for installation in concrete walls where power, distribution and controls are required in an aesthetically appealing environment. The flush-mount design enables safe clean installation, and the lockout tab ensures additional security.

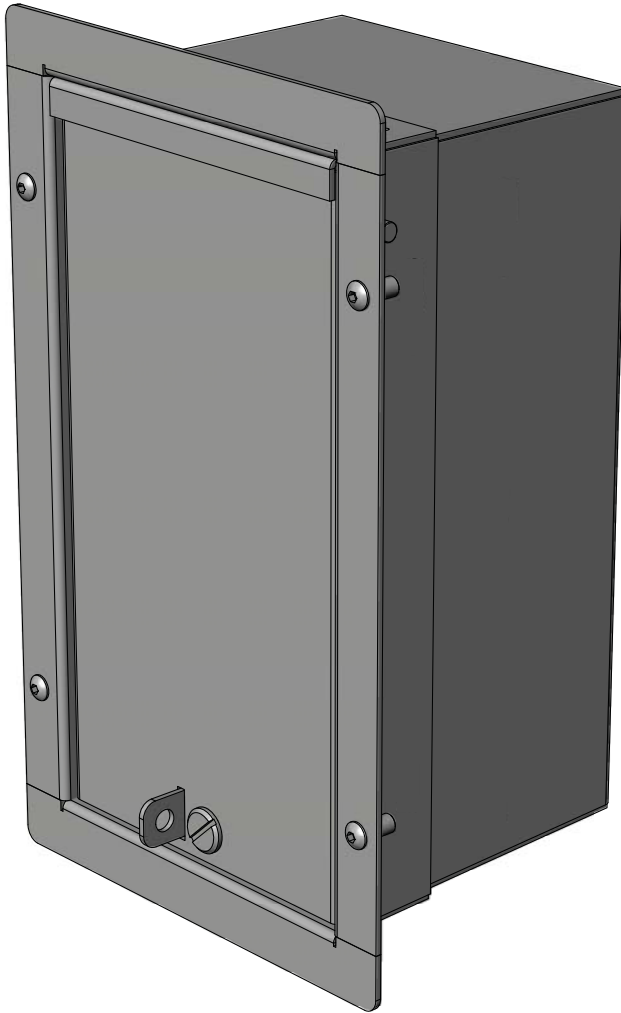

Features

- Aluminum construction
- NEMA 3R rated
- Cast-in-place design
- Used for wall mounting
- Flush-mount design
- Flip door design with tooled entry style latch
- Breaker protected outlet
- Power distribution lugs for loop feeders
- Detailed installation instructions in each enclosure

Specifications

- 120/240 VAC 1 phase
- ETL certified to applicable CSA and UL standards
- 10,000 AIR

Optional Components

- Multiple receptacle configurations
- Padlock tab
- Flasher controls
- Up to 22 kAIC rated breakers
- Alternate latch types

Benefits

This cast-in-place design enables convenient access to electrical points in a flush mount designed enclosure. The padlock tab allows additional security.



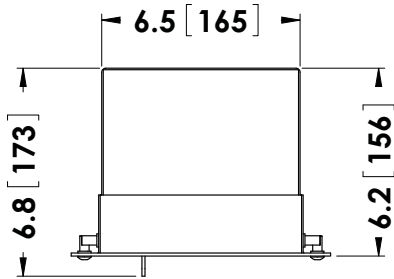

**TOP VIEW
(DOOR CLOSED)**

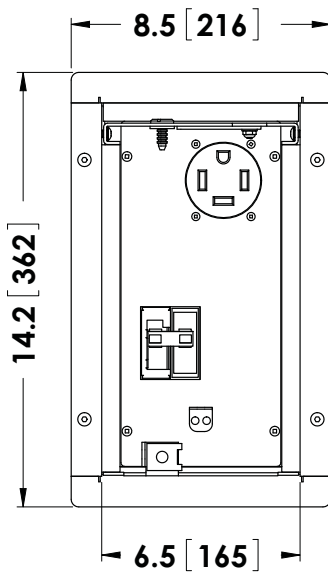

**FRONT VIEW
(DOOR OPEN)**

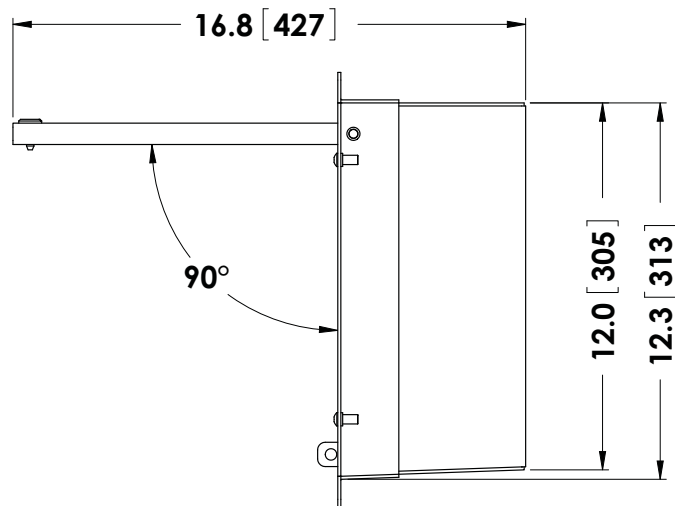

**SIDE VIEW
(DOOR OPEN)**

PART NUMBER	HEIGHT	WIDTH	DEPTH	MATERIAL	MAIN BREAKER	RECEPTACLE
CIPW115	14"	6.5"	6.25"	ALUMINUM	1-15A 1P	1-15A GFI DUPLEX
CIPW215	14"	6.5"	6.25"	ALUMINUM	2-15A 1P	2-15A GFI DUPLEX
CIPW315	14"	6.5"	6.25"	ALUMINUM	3-15A 1P	3-15A GFI DUPLEX
CIPW120	14"	6.5"	6.25"	ALUMINUM	1-20A 1P	1-20A GFI DUPLEX
CIPW220	14"	6.5"	6.25"	ALUMINUM	2-20A 1P	2-20A GFI DUPLEX
CIPW320	14"	6.5"	6.25"	ALUMINUM	3-20A 1P	3-20A GFI DUPLEX
CIPW130	14"	6.5"	6.25"	ALUMINUM	1-30A 2P	1-30A 120/240V
CIPW150	14"	6.5"	6.25"	ALUMINUM	1-50A 2P	1-50A 120/240V

FOR ADDITIONAL OPTIONS CONSULT FACTORY